



Louise W. Moore County Park Arboretum



Discover all
that's taking
root here!



Louise W. Moore County Park Arboretum

151 Country Club Road
Easton, PA 18045
610.829.6400

norcopa.gov/parks-and-recreation



Where beauty, majesty, serenity, and history grow

Designed by George E. Patton & Associates, the most prolific landscape architectural firm of the 20th century, the Louise W. Moore County Park Arboretum spans the park's 120 acres and invites visitors to escape to nature's beauty and majesty.

Awarded Level I Accreditation by ArbNet in 2024 based on its level of achievement of professional standards and practices, the arboretum features:



ORIGINAL PLANTINGS

Trees and shrubs selected as part of George E. Patton & Associates 1976 design plan stand today and honor Louise Moore's gift to the community.

BICENTENNIAL GROVE

Five eastern hemlocks, Pennsylvania's state tree, commemorate the 1987 bicentennial of the signing of the U.S. Constitution.

MATSON'S WOODS

A seven-acre forest of centuries-old red and white oaks complements the surrounding open landscape and the visitor experience.

AGROFORESTRY PLOTS

Sixty grafted trees (cultivars) from the John Hershey Nut & Edible Fruit Tree Nursery & Farm in Downingtown, PA, create new generations of these historical trees and allow John Hershey's life's work to live on.

SALEM OAK

A seedling grafted from a twig of the famous 600-year-old Salem oak of Salem County, NJ, carries on the name and legacy of this celebrated tree.

A picturesque oasis, the arboretum serves as a glorious backdrop, whether hiking the park's trails, hosting a gathering in one of the pavilions, admiring the wildflower gardens, or marveling at the sights and sounds of nature and wildlife. Come explore its ever-growing magnificence!





Louise W. Moore County Park Arboretum

Arboretum Map

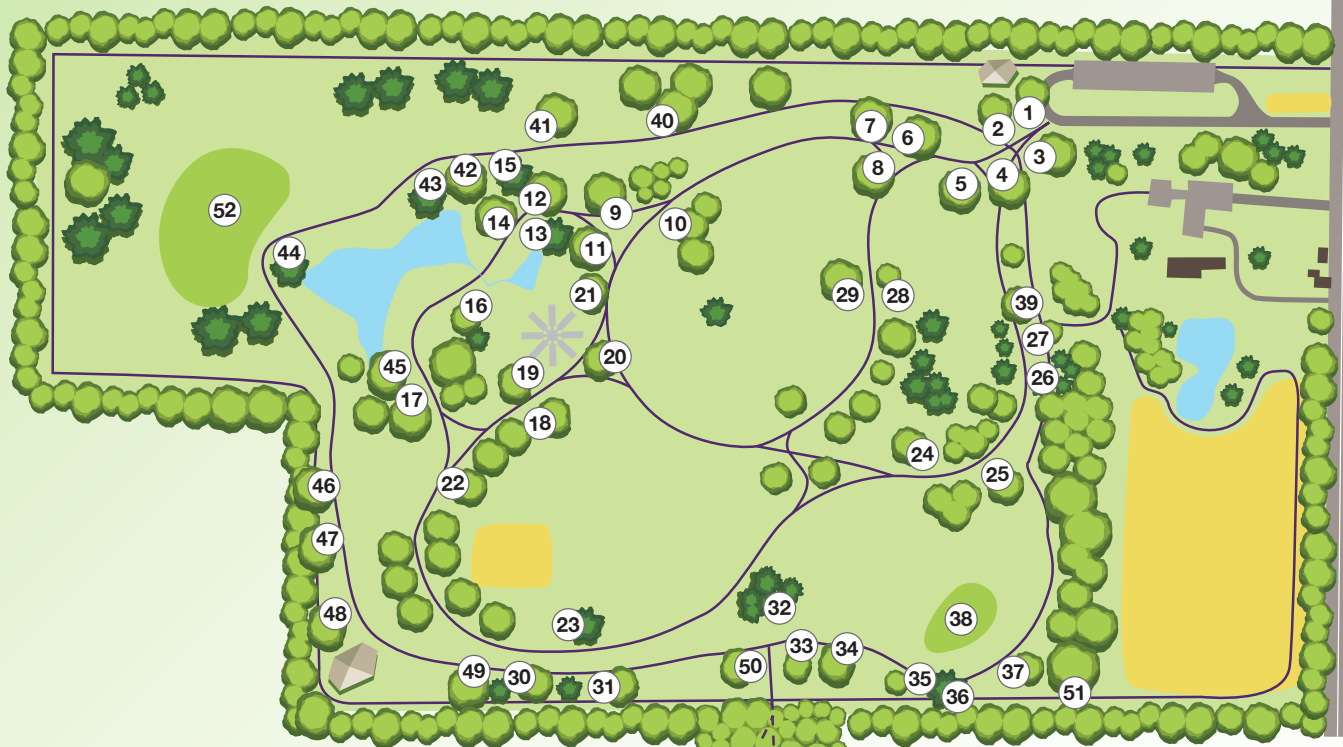

-  Native Wildflower Meadows
-  Community Gardens
-  Parking Lots
-  County Park Buildings
-  Walking Trails
-  Pavilions
-  Windmill

1. White Oak *Quercus alba*
2. Red Oak *Quercus rubra*
3. Swamp White Oak *Quercus bicolor*
4. English Oak *Quercus robur*
5. Crimean Linden *Tilia x euchlora*
6. Silver Linden *Tilia tomentosa*
7. American Linden *Tilia americana*
8. Littleleaf Linden *Tilia cordata*
9. Katsura Tree *Cercidiphyllum japonicum*
10. Lacebark Elm *Ulmus parvifolia*
11. Japanese Pagoda Tree *Styphnolobium japonicum*
12. Ginkgo Biloba *Ginkgo biloba*
13. Japanese Larch *Larix leptolepis*
14. Japanese Maple *Acer palmatum*
15. European Larch *Larix decidua*
16. Kwanzan Cherry *Prunus serrulata*
17. River Birch *Betula nigra*

18. Magnolia *Magnolia spp.*
19. Quaking Aspen *Populus tremuloides*
20. Kousa Dogwood *Cornus kousa*
21. Paperbark Maple *Acer griseum*
22. Saucer Magnolia *Magnolia x soulangeana*
23. Blue Atlas Cedar *Cedrus atlantica*
24. European Hornbeam *Carpinus betulus*
25. European Beech *Fagus sylvatica*
26. Fernleaf European Beech *Fagus sylvatica 'Asplenifolia'*
27. European Beech *Fagus sylvatica*
28. Korean Spice Viburnum *Viburnum carlesii*
29. London Planetree *Platanus x acerfolia*
30. Sweet Birch *Betula lenta*
31. Horse Chestnut *Aesculus hippocastanum*
32. Bicentennial Grove – Eastern Hemlock *Tsuga canadensis*
33. Grey Birch *Betula populifolia*
34. Sourwood *Oxydendrum arboreum*
35. Flowering Dogwood *Cornus florida*
36. Balsam Fir *Abies balsamea*
37. Kentucky Coffeetree *Gymnocladus dioica*
38. Honey Locust Cultivar Grove *Gleditsia spp.*
39. Weeping European Beech *Fagus sylvatica 'Pendula'*
40. Red Maple *Acer rubrum*
41. White Oak *Quercus alba*
42. Contorted Willow *Salix matsudana*
43. Dawn Redwood *Metasequoia glyptostroboides*
44. Bald Cypress *Taxodium distichum*
45. Sweet Gum *Liquidambar styraciflua*
46. Carolina Silverbell *Halesia carolina*
47. Cucumbertree *Magnolia acuminata*
48. Japanese Zelkova *Zelkova serrata*
49. Tulip Poplar *Liriodendron tulipifera*
50. Blackhaw Viburnum *Viburnum prunifolium*
51. Northern Catalpa *Catalpa speciosa*
52. Hickory & Walnut Cultivar Grove *Carya spp. & Juglans spp.*
53. Matson's Woods – White & Red Oaks *Quercus alba & Quercus rubra*
54. Mulberry Cultivar Grove *Morus spp.*
55. Canada Hemlock *Tsuga canadensis*
56. Sugar Maple *Acer saccharum*
57. Amur Maple *Acer ginnala*
58. Persimmon Cultivar Grove *Gleditsia spp.*